

Product Search Advisor

This module is a chargeable module, if you are interested in this module, please reach out to our admin team on the following link to inquire [Click Here](#)
If you have already purchased this module, please continue.

Introduction

Our product search advisor is a powerful tool that allows your customer to quickly search and find a product using an advanced configuration of your filters across your products to drive this quick catalogue search using a smart intuitive interface. Please see a basic user interaction using the advisor below.

To briefly explain the video, this allows the user to select a category, and using your own configuration of the advisor you can guide your customers to shop by relevant results related to those categories. For example, TVs to be shopped by size, laundry to be filtered by load size, and/or installation type, and this can all be configured using our smart front end utility.

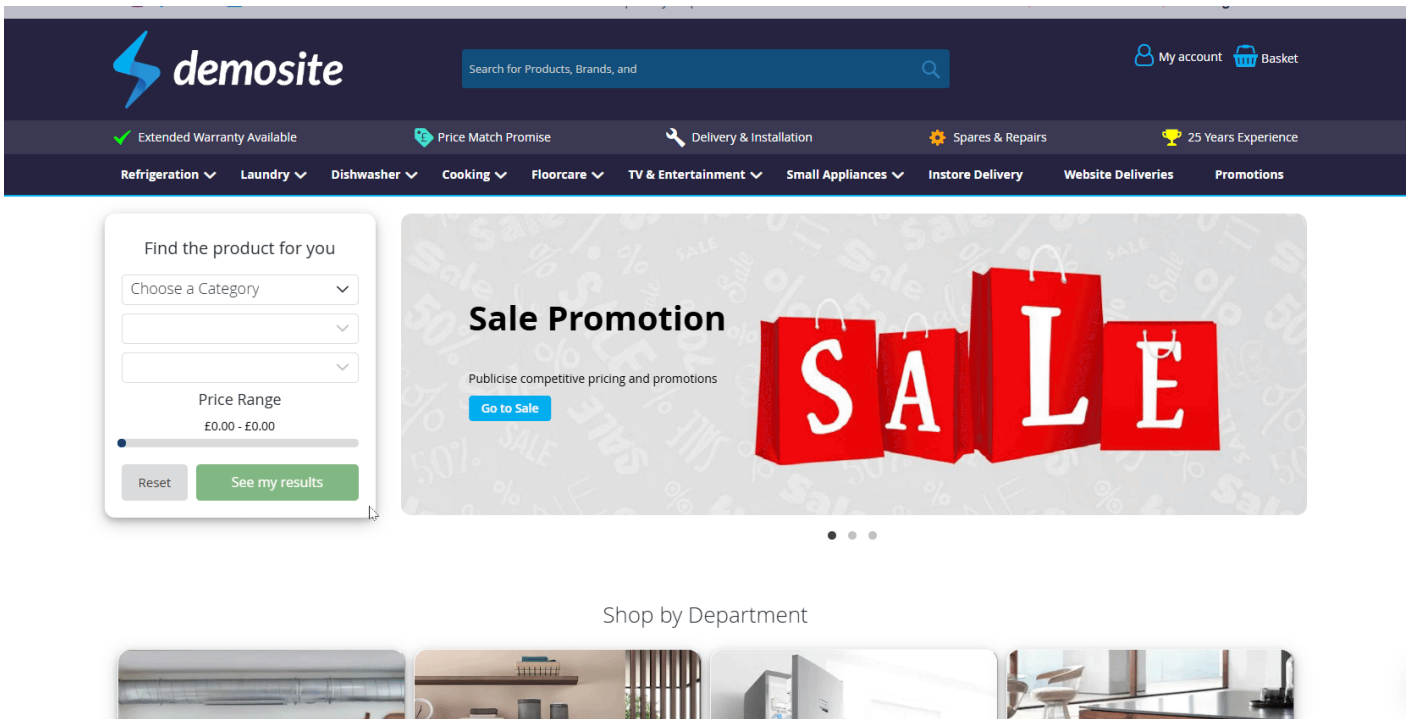

once this module is enabled for you, a front-end utility becomes available to you to use in a variety of different configurations. it will display by default all categories available to you.

Dynamic Filters Configuration

Open the Configurator

Navigate to **Calculus > Product Advisor**

Product Advisor Configurator

🔍 Calculus_Sen

**Product Advisor**

Use the Product Advisor Configurator to set the second and third advisor filters for each cached advisor category. The page highlights where products are missing the configured filter values and allows customers to export reports so those data gaps can be identified and corrected. Regenerate the Product Advisor cache if categories or attributes are missing.

Scope: **Default Config** **Module Enabled** **Regenerate cache after category or attribute changes.**

GROUPS: 7 **CATEGORIES: 35** **PRODUCTS: 490**

MISSING FILTER 2: 0 **MISSING FILTER 3: 0**

Save Product Advisor Settings

Search categories

Search by category or group name

Export Missing Filter Report

Expand All

Collapse All

COOKING 9 Categories

Configure dynamic filter steps for cached categories in this group.

Products: 103 Missing Filter 2: 0 Missing Filter 3: 0

| CATEGORY | PRODUCTS | FILTER 2 | FILTER 2 LABEL | FILTER 3 | FILTER 3 LABEL |
|---------------------|---------------------------|---------------------------|-----------------------|----------------|-----------------------|
| #1144 Air Fryers | 1 Products in category | -- Use static settings -- | Select Filter 2 Label | -- Disabled -- | Select Filter 3 Label |
| #936 | 3 | | | | |

Save Configuration

From here you will see each parent category separated into its own block. Within each block you will configure the specific attributes which will be used for the sub department.

Configure Attributes

In the example bellow we have used the Washing/Drying Capacity attributes as Filter 2, the manufacturer as Filter 3 and adjusted the labels accordingly.

| | | | | | |
|--------------------------|----------------------------|--------------------|-------------------------|-------------------|---------------------|
| #977 Tumble Dryers | 17 Products in category | Capacity (Kg) (17) | Select Drying Capacity | Manufacturer (17) | Select Manufacturer |
| #980 Washer Dryers | 8 Products in category | Capacity (Kg) (8) | Select Washing Capacity | Manufacturer (8) | Select Manufacturer |
| #983 Washing Machines | 27 Products in category | Capacity (Kg) (26) | Select Washing Capacity | Manufacturer (27) | Select Manufacturer |

You can see how this will look on the website here:

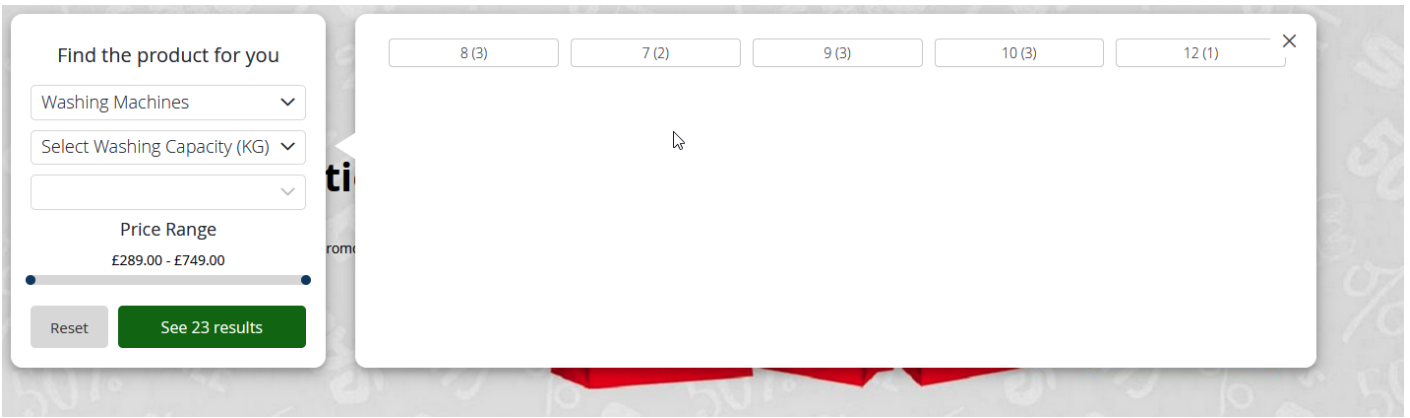

Missing Attributes

You can see here that there are 13 products in **Floorcare** but only 10 have the **Colour** attribute.

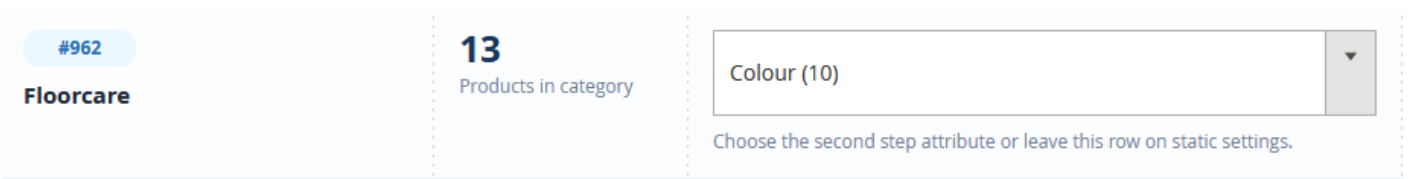

To view all products that are missing filter attributes, click **Export Missing Filter Report** in the top right of the page.

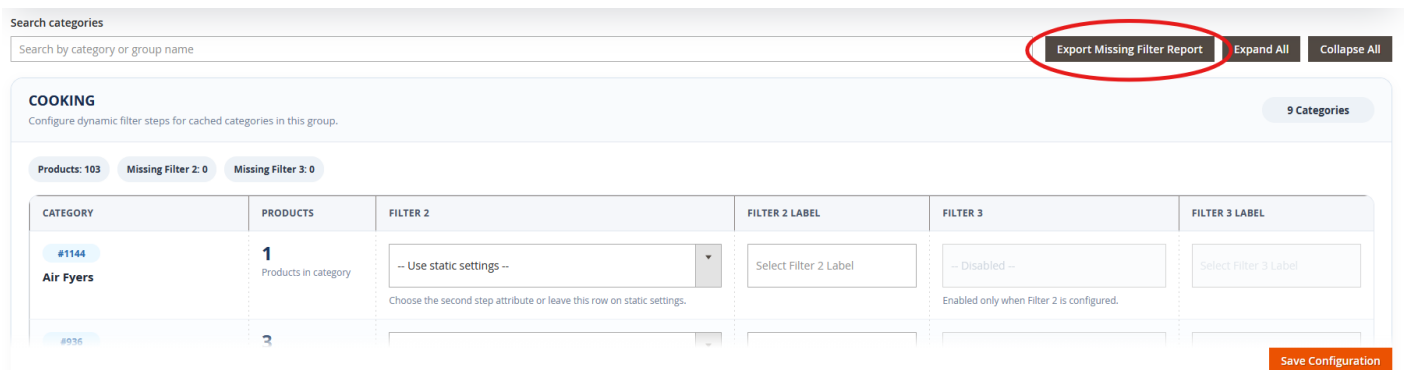

This will then generate an Excel file of all missing attributes from individual products.

Save Changes

Once you have finished configuring your filters you must press **Save Configuration** at the bottom of the page and flush the cache.

Floorcare
Configure dynamic filter steps for cached categories in this group. 2 Categories

Laundry
Configure dynamic filter steps for cached categories in this group. 3 Categories

Refrigeration
Configure dynamic filter steps for cached categories in this group. 5 Categories

Small Appliances
Configure dynamic filter steps for cached categories in this group. 9 Categories

TV, Audio & Gaming
Configure dynamic filter steps for cached categories in this group. 8 Categories

[Save Configuration](#)

Optional: Search Advisor Widget

With the Products Search Advisor enabled you will also have the ability to inject the advisor as a widget throughout the site but with some caveats.

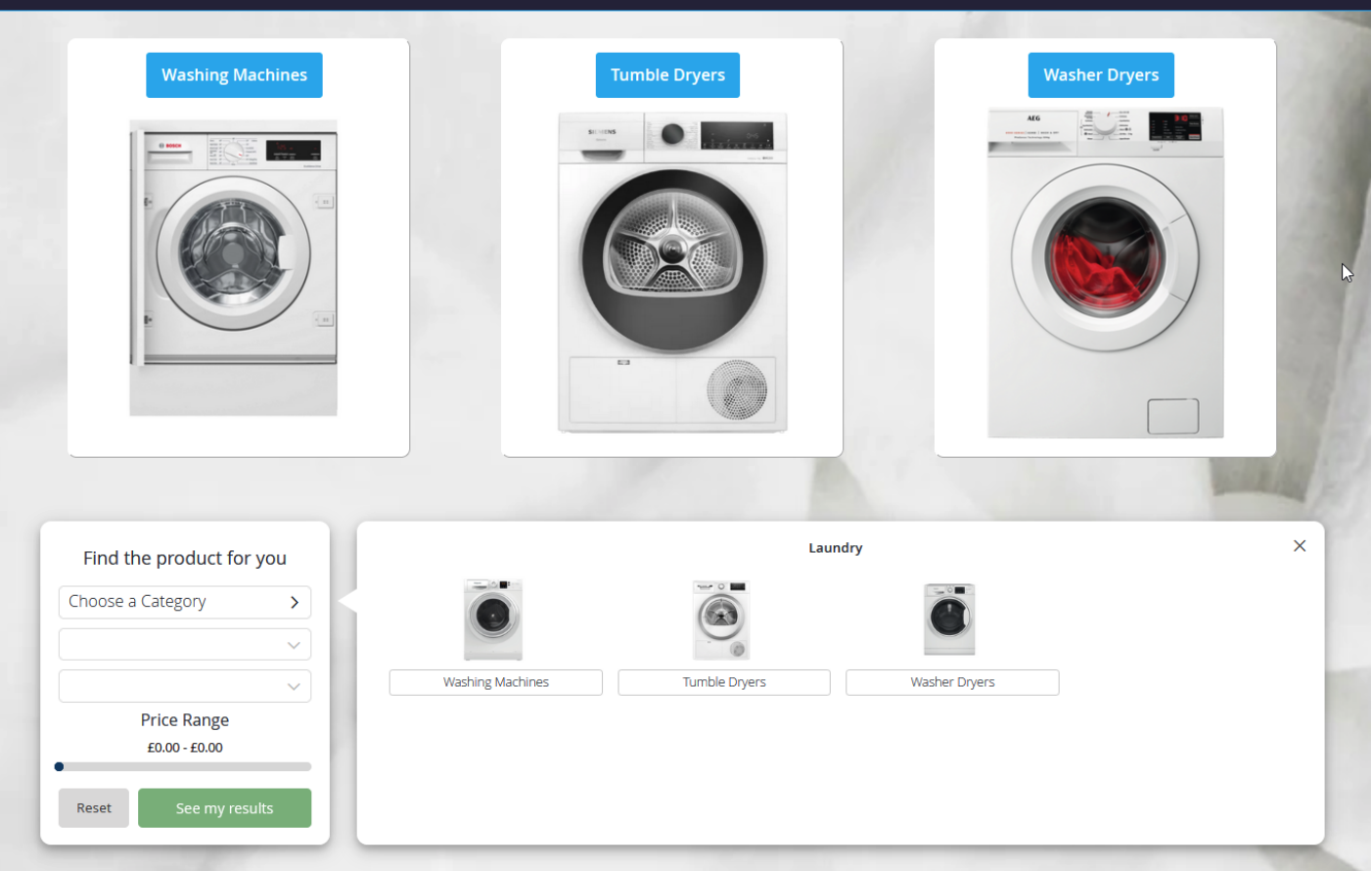

In the example above the advisor has been added to a laundry landing page and displays just the sub departments of Laundry in the first filter. This is achieved using a HTML code element in Magento's page builder.

Start with adding a HTML code element to your block or page. Once added, select the  icon that appears when hovering over the element. In here you will select **Insert Widget...** and select product advisor from the Widget Type dropdown.

widget instance.

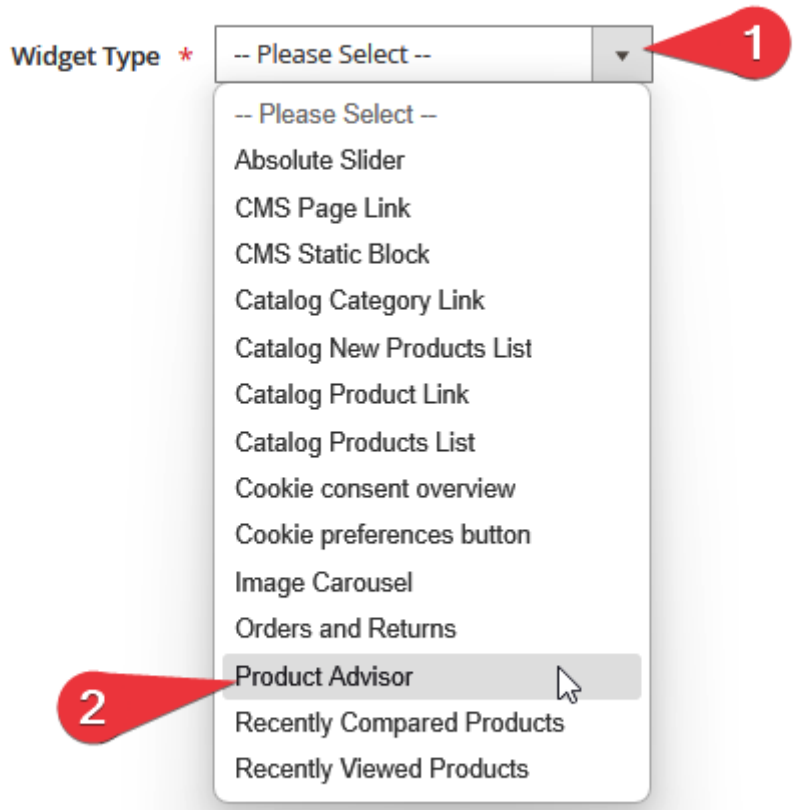

You should no see a new dropdown called Category. Select the parent department you want to use for the first filter.

NOTE: The advisor can only use a single department when used as a widget.

Widget Type * Product Advisor ▼

Widget Options

Category (New Products) ▼

- (New Products)
- Services
- Refrigeration
- Cooking
- Laundry**
- Floorcare
- Small Appliances
- Dishwasher
- Sinks & Taps
- Commercial Appliance
- TV & Entertainment
- Test
- Spares
- Install_Deliver

Insert Widget

Once you have selected your department, now press **Insert Widget** and save your block/page.

Created 2025-06-06 06:17:47 UTC by Jordan Lane
Updated 2026-06-04 08:32:13 UTC by Nathan Cornwall